

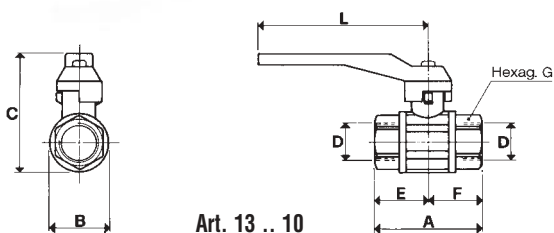

[Hand-operated 2- and 3-way vacuum valves]

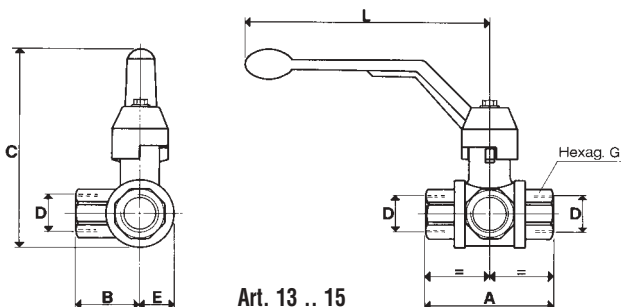

Art. 13 .. 10



Art. 13 .. 15

These hand-operated valves are used to intercept vacuum in those circuits where it is not possible to use solenoid valves.

They consist of a body in die-cast brass, turned and nickel-plated, a ball valve in steel chromium plated at thickness and teflon gaskets in order to guarantee a seal even in high temperature applications.

A long lever pivoted on the ball valve, turned by hand through 90°, opens or closes the valve accurately and with minimal effort.

At present these valves are available in the 2- and 3-way versions with sizes up to 3" gas.

Art.	A	B	C	D Ø	E	F	G	L
13 01 10	49	26	56	1/4"	25.0	24	21	91
13 02 10	49	26	56	3/8"	25.0	24	21	91
13 03 10	57	32	62	1/2"	29.0	28	26	91
13 04 10	69	39	70	3/4"	35.0	34	32	116
13 05 10	81	48	83	1"	41.0	40	39	116
13 06 10	97	62	102	1"1/4	49.0	48	49	150
13 07 10	99	69	112	1"1/2	50.0	49	56	145
13 08 10	115	83	135	2"	58.0	57	68	180
13 09 10	170	140	210	3"	86.0	84	99	225
13 01 15	52	26	98	1/4"	14.5	--	22	130
13 02 15	52	26	98	3/8"	14.5	--	22	130
13 03 15	69	33	104	1/2"	18.5	--	27	130
13 04 15	78	39	105	3/4"	22.0	--	32	130
13 05 15	89	45	107	1"	27.0	--	40	130
13 06 15	118	59	144	1"1/4	35.5	--	50	205
13 07 15	141	71	157	1"1/2	43.5	--	57	205