

[Plunger valves]



Plunger valves consist of a cylindrical brass body, a steel plunger with a conical valve and a thrust spring.

Connected to vacuum, they are normally closed; they open when operating on the plunger.

Their function is to open the suction and consequently to make vacuum in the cup, only when the plunger valve gets in contact with the taking surface. They are available in different types and they are all suitable to our cups.

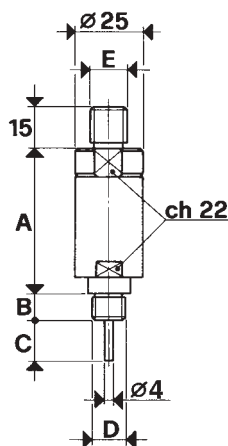

Art. 19 01 10
19 01 11
19 01 12

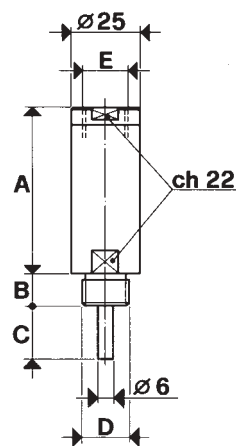

Art. 19 02 10
19 03 10
19 04 10

Art.	A	B	C	D Ø	E Ø
19 01 10	53	9	15.0	1/4"	1/4"
19 01 11	53	9	15.0	M12	1/4"
19 01 12	53	9	21.5	M12	1/4"
19 02 10	61	12	20.0	3/8"	3/8"
19 03 10	61	10	22.0	1/2"	3/8"
19 04 10	68	10	40.0	1/2"	3/8"