

Vacuum regulators with pneumatic adjustment

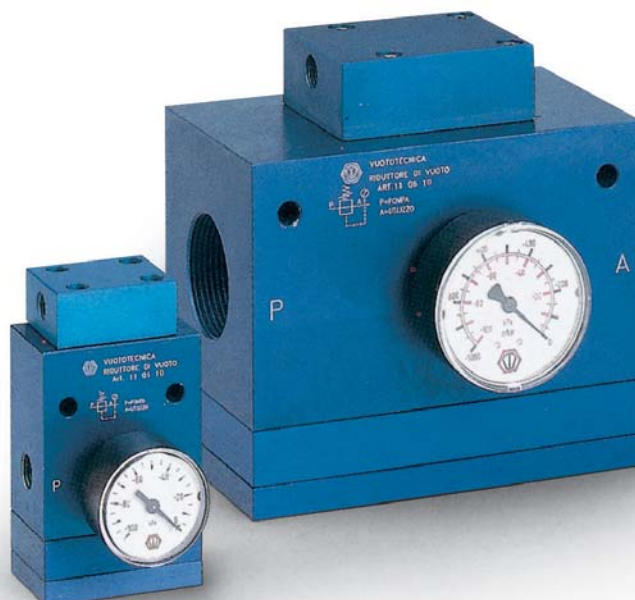

Distinctive features

Vacuum regulators are used to adjust the vacuum degree and to keep it constant at the preset value (secondary depression) independently of the capacity and of the oscillations of the vacuum degree of the pump or of the pumpset (primary depression).

Unlike vacuum adjusting valves, regulators do not introduce air into the circuit, this permits to produce more grip points at different vacuum values, from one only depression source.

Their operating principle is based on the contrasting action between a pneumatic cylinder with short stroke and a fluctuating piston driven by the pressure differential existing between the secondary depression and the atmospheric pressure.

In order to adjust the vacuum degree of the regulator it is necessary to operate on the pressure of the compressed air for feeding the pneumatic cylinder: higher is the pressure, higher is the vacuum degree, and vice versa.

Technical features:

- Supply pressure: from 0 to 3 bar(g) for the regulators Art. 11 .. 30; from 0 to 7 bar(g) for the regulators Art. 11 .. 80.
- Adjustable working pressure: from 800 to 1 mbar abs. for the regulators Art. 11 .. 30; from 980 to 1 mbar abs. for the regulators Art. 11 .. 80.
- Capacities: from 2 to 160 cum/h;
- Room temperature: from -10°C to +80°C.
- Mounting: any position.

Applications

Vacuum regulators are generally used on the centralized plants, where, independently of the vacuum degree of the plant, every vacuum point can be adjusted to its own value.

It is also necessary every time that the working depression has to be lower than the primary depression and to be kept constant.

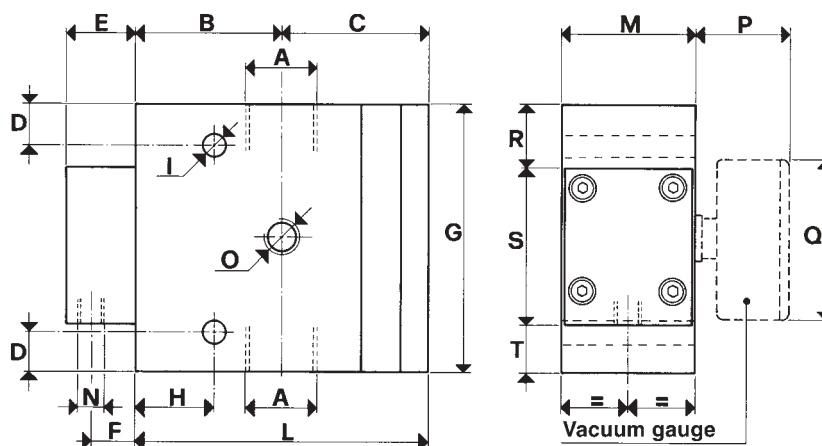

Art. 09 03 10

Art. 09 03 15 per 11 01 30

11 02 30

Art.	A	Max cap.	B	C	D	E	F	G	H	I	L	M	N	O	P	Q	R	S	T
	Ø	cum/h.								Ø			Ø	Ø	Ø				
11 01 30	1/4"	6	47	42	10	20	10.5	60	20	6.5	89	40	1/8"	1/8"	30	40	9	45	6
11 02 30	3/8"	10	47	42	10	20	10.5	60	20	6.5	89	40	1/8"	1/8"	30	40	9	45	6
11 03 30	1/2"	20	53	52	15	26	16.5	85	25	8.5	105	50	1/8"	1/4"	36	63	16.5	58	10.5
11 04 30	3/4"	40	55	55.5	15	26	16.5	100	30	8.5	110.5	50	1/8"	1/4"	36	63	24	58	18
11 05 30	1"	80	60	58	15	26	16.5	120	30	8.5	118	60	1/8"	1/4"	36	63	34	58	28
11 06 30	1 1/2"	160	54	77.5	15	30	19.5	160	20	8.5	131.5	99	1/4"	1/4"	36	63	37.5	80	42.5
11 03 80	1/2"	20	53	52	15	26	16.5	120	25	8.5	105	60	1/8"	1/4"	36	63	34	58	28
11 05 80	1"	80	60	58	15	26	16.5	120	30	8.5	118	100	1/8"	1/4"	36	63	34	58	28
11 06 80	1 1/2"	160	54	77.5	15	30	19.5	160	20	8.5	131.5	99	1/4"	1/4"	36	63	37.5	80	42.5

N.B. - The vacuum gauge is supplied only upon request.

