

## [Supports with retractable reference pin]



The supports with reference pin described on this page have been manufactured in order to allow quick centering of the load to be stirred with cups to the operating surface of the machines.

The reference pin, integral with a piston, is operated by vacuum while retracting and remaining in its own seat and by a stainless steel spring while coming out.

These supports are mechanically fixed to the operating surface.

The reference pin is made in plastic material, while the support is in anodized anticorrosional aluminium.

As a standard they are equipped with a rapid fitting for connection to vacuum.

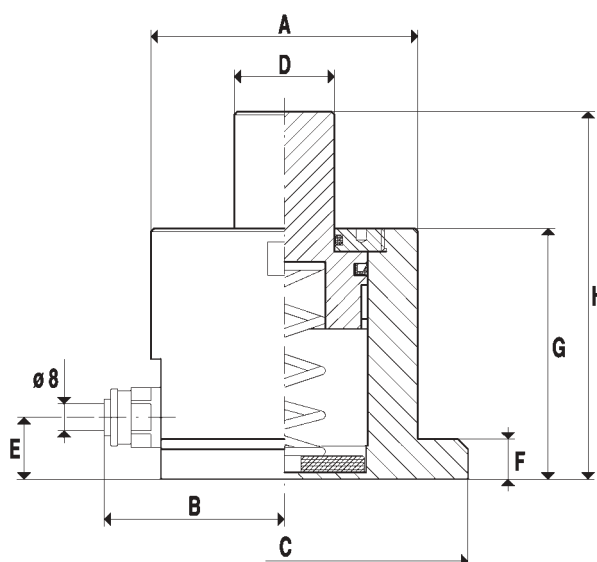

Art.	A Ø	B	C Ø	D Ø	E	F	G	H
23 01 10	80	53	110	30	18	12	45	63
23 01 15	80	53	110	30	13	12	64	99
23 02 10	80	53	110	30	18	12	75	110
23 05 10	80	53	110	30	18	12	110	180

